



...connecting to the aftermarket

# INSTALLATION INSTRUCTIONS FOR PART CT24CH04

## APPLICATIONS

**2004-05 Dodge Durango /  
2005 Chrysler 300 / 2005 Dodge Magnum /  
2005 Jeep Grand Cherokee**

# CT24CH04



### KIT FEATURES

- DIN Head Unit Provisions with Pocket
- ISO DIN Head Unit Provisions with Pocket

### KIT COMPONENTS

A) Radio Housing | B) ISO Snap-In Brackets | C) Trim Plates (upper & lower)

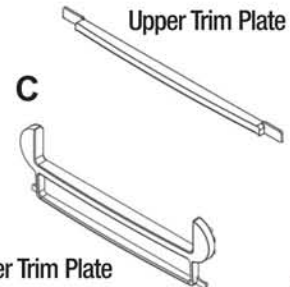
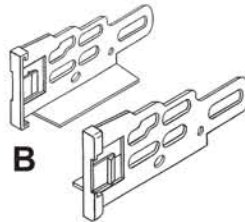
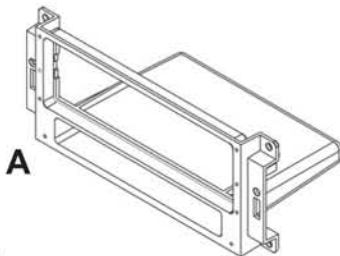

### TOOLS REQUIRED:

Phillips Screwdriver | Socket Wrench



[www.connects2.com](http://www.connects2.com)

**TABLE OF CONTENTS**

**Dash Disassembly**

- **2004-05 Dodge Durango** ..... **1**
- **2005 Chrysler 300** ..... **2**
- **2005 Dodge Magnum** ..... **3**
- **2005 Jeep Grand Cherokee** ..... **4**

**Kit Assembly**

- **ISO Head Unit Provision with Pocket** ..... **5**
- **DIN Head Unit Provision with Pocket** ..... **6**

**Final Assembly** ..... **7**

**Notes** ..... **8-9**

## **2004-05 DODGE DURANGO**

- 1** Disconnect the negative battery terminal to prevent an accidental short circuit.
- 2** Remove (2) 7MM screws from the inside of the pocket facing upward. **Figure A**
- 3** Unclip and remove the entire trim panel surrounding the radio and climate controls. **Figure B**
- 4** Remove (4) 7MM screws securing radio to dash to remove. **Figure C**

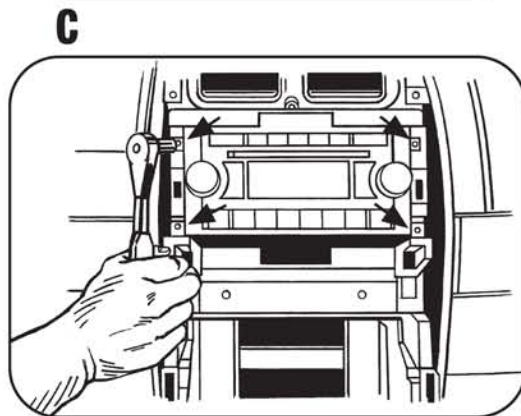
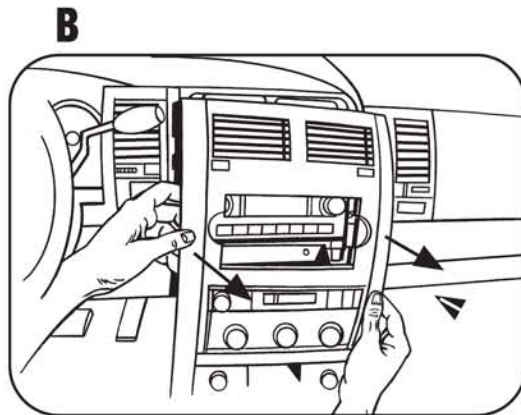
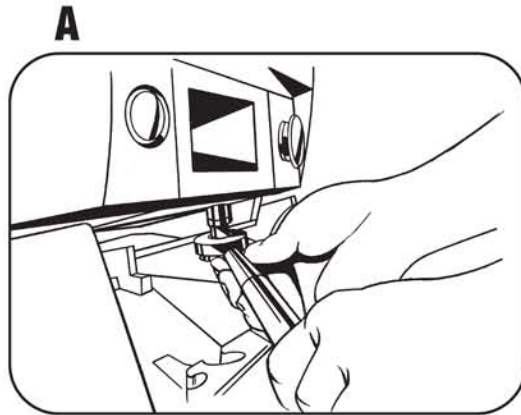

**DASH DISASSEMBLY**

**2005 CHRYSLER 300**

- 1** Disconnect the negative battery terminal to prevent an accidental short circuit.
- 2** Unclip and remove entire panel surrounding radio and climate controls, including a/c vents and clock. **Figure A**
- 3** Remove (4) 7MM screws securing radio to dash to remove. **Figure B**

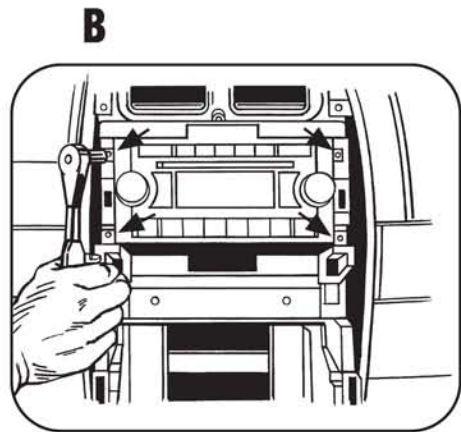
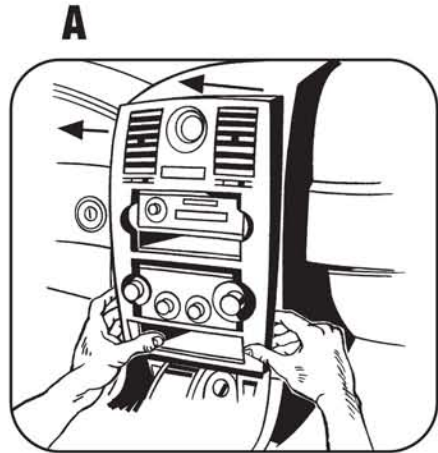

## **2005 DODGE MAGNUM**

- 1** Disconnect the negative battery terminal to prevent an accidental short circuit.
- 2** Unclip and remove entire panel surrounding radio and climate controls, including a/c vents. **Figure A**
- 3** Remove (4) 7MM screws securing radio to dash to remove. **Figure B**

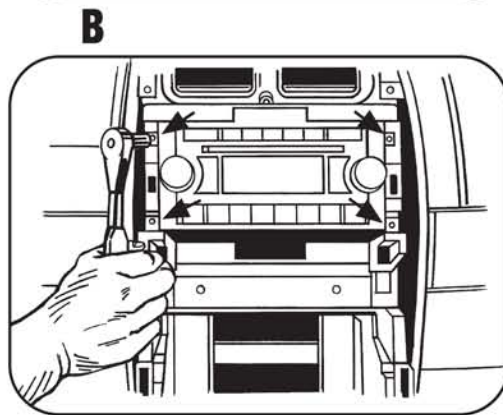
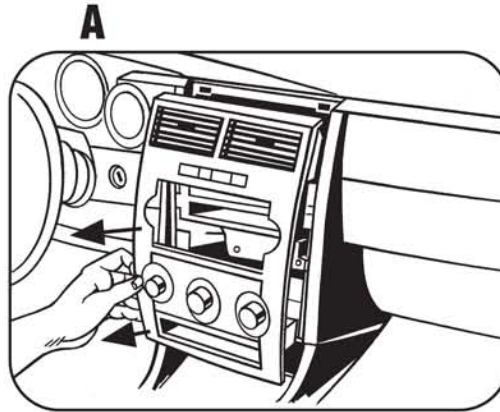

**DASH DISASSEMBLY**

# DASH DISASSEMBLY

## 2005 JEEP CHEROKEE

- 1 Disconnect the negative battery terminal to prevent an accidental short circuit.
- 2 Unsnap and remove panel from around radio including the vent on each side.  
**Figure A**
- 3 Remove (4) Phillips screws to remove.  
**Figure B**

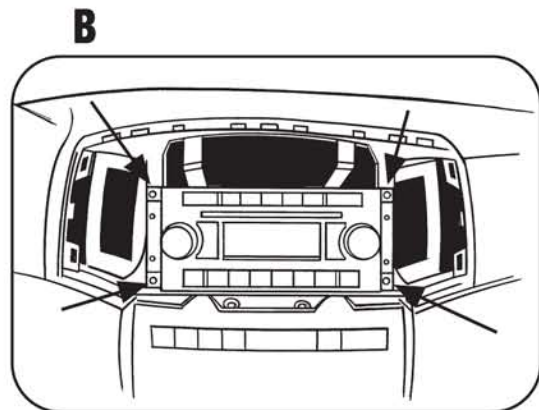
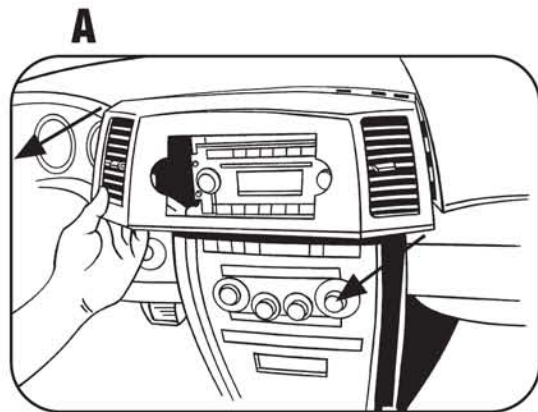

**DIN HEAD UNIT PROVISION**

**A**

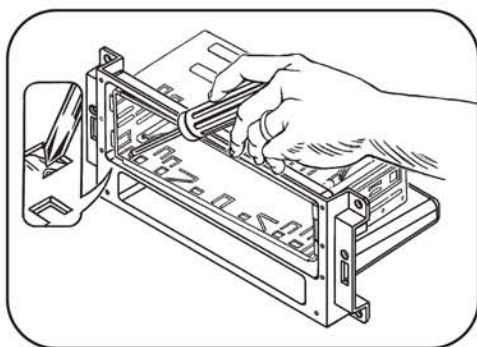

**NOTE:** You will need to remove the aftermarket radio's trim ring if equipped.

- 1** Slide the DIN cage into the Radio Housing and secure by bending the metal locking tabs down.

**Figure A**

**B**

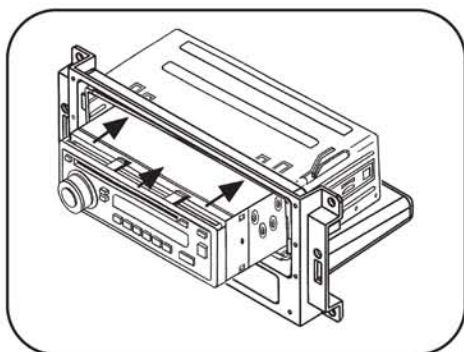

- 2** Slide the after-market head unit into the cage and secure. Snap trim plate into the radio housing.

**Figure B**

**C**

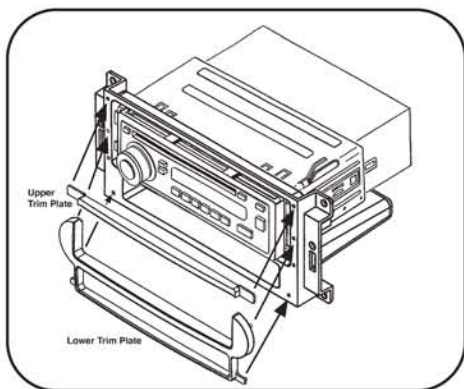

- 3** Using the alignment pins on the trim plates & the corresponding holes in the housing, attach the upper trim plate and the lower trim plate supplied with the kit.

**Figure C**

## **ISO DIN HEAD UNIT PROVISION**

**A**

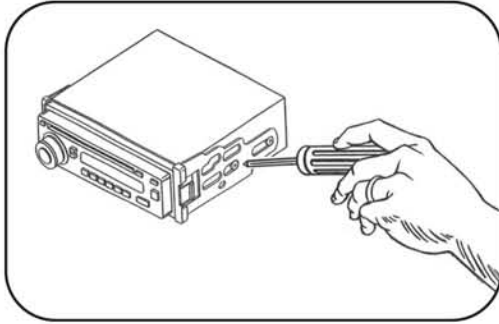

- 1** Slide the DIN cage into the Radio Housing and secure by bending the metal locking tabs down.

**Figure A**

**B**

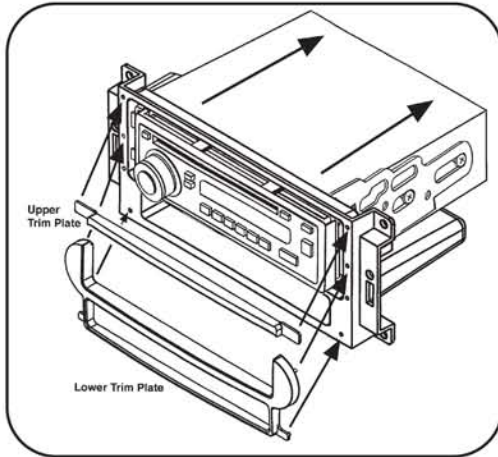

- 2** Slide the after-market head unit into the cage and secure. **Figure B**

- 3** Using the alignment pins on the trim plates & the corresponding holes in the housing, attach the upper trim plate and the lower trim plate supplied with the kit.

**Figure B**



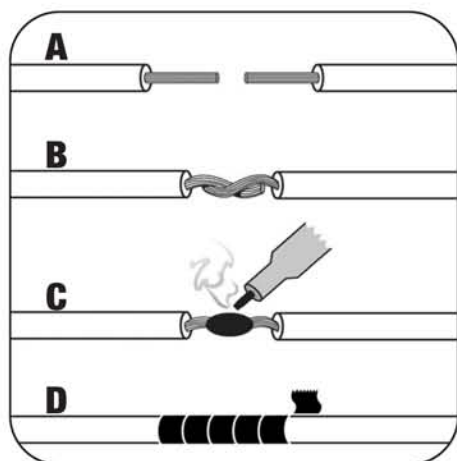

- A) Strip wire ends back 1/2"**
- B) Twist ends together**
- C) Solder**
- D) Tape**

- 1** Locate the factory wiring harness in the dash. We recommend using the proper mating adapter and making the connections as shown. (Isolate and individually tape off the ends of any unused wires to prevent electrical short circuit).
- 2** Secure the kit into the sub dash using the (4) 7mm screws that secured the factory radio.
- 3** Re-connect the negative battery terminal and test the unit for proper operation.
- 4** Reassemble dash in reverse order of disassembly.